



Benworth Street, London, E3

BUTLER & STAG



Guide Price - £400,000 to £425,000
Located in the heart of Bow, this ex-local authority two-bedroom split-level maisonette offers over 800 square feet of generous living space. With a balcony, well-proportioned rooms, and a practical layout, this home is perfect for first-time buyers, families, or investors looking for a well-connected London property.



Leasehold

- Two Double Bedrooms
- Ample Storage Throughout
- Close To Stations (Mile End Station, Bow Road Station, DLR Bow Church)
- Close To Victoria Park
- Good Condition
- Chain Free
- Lift Access
- Parking Permit (On Application)

Two spacious bedrooms – both well-sized with ample natural light.

Split-level layout – separating living and sleeping areas for enhanced privacy.

Well-maintained kitchen – offering plenty of storage and workspace.

Additional Benefits:

Permit parking available on application – for easy access to residential parking.

Chain-free sale – simplifying the buying process.

Good condition throughout – ready for immediate move-in or rental investment.

Prime Location:

Perfectly positioned between Bow Road and Victoria Park, this home benefits from excellent transport links and green spaces:

Transport: A short walk to Bow Road Underground Station (District & Hammersmith & City lines) and Bow Church DLR, providing quick access to The City, Canary Wharf, and Stratford.

Local amenities: Close to shops, cafes, and supermarkets, ensuring everyday essentials are within easy reach.

This well-presented and chain-free maisonette is an excellent opportunity to own a spacious home in a desirable East London location.



Howcroft House

Approx. Gross Internal Area 76.6 Sq M (824 Sq Ft)

BUTLER & STAG



First Floor

Approx. 32.8 sq. metres (352.6 sq. feet)

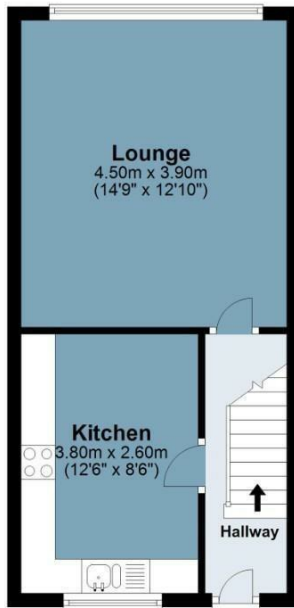

Second Floor

Approx. 43.8 sq. metres (471.4 sq. feet)

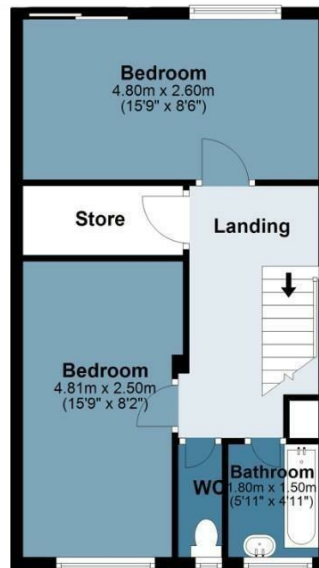

Measurements are approximate and for illustration purposes only. While we do not doubt the accuracy and completeness, we advise you conduct a careful independent assessment of the property to determine monetary value.
© @modephoto.uk www.modephoto.co.uk

IMPORTANT NOTICE - These particulars have been prepared in good faith and they are not intended to constitute part of an offer or contract. We have not performed a structural survey on this property and the services, appliances and specific fittings have not been tested. All photographs, measurements, floor plans and distances referred to are given as a guide and should not be relied upon.

BUTLER & STAG

☎ 020 8102 1236

🏠 508 Roman Road, Bow, London, E3 5LU

✉ bow@butlerandstag.com

www.butlerandstag.uk